



**Legend**

- Application boundary
- Limits of deviation for work no.1 a) Local Equipment Room and Control (including battery enclosure)
- Limits of deviation for work no.1 b & c) Generator and Gas Turbine
- Limits of deviation for work no.1 d) Heat Recovery Steam Generator
- Limits of deviation for work no.1 e) 70M High Heat Recovery Steam Generator Stack
- Limits of deviation for work no.1 f) Turbine Hall (including steam turbine)
- Limits of deviation for work no.1 g) CHP Pipe Bridge, including pipes and cables
- Limits of deviation for work no.1 h) Dump Condenser
- Limits of deviation for work no.1 i) Fin Fan Cooler
- Limits of deviation for work no.1 j) 35m high Package Boiler Stack
- Limits of deviation for work no.1 k-w) Ancillary plant items

© 2018 RPS Group

**Notes**

1. This drawing has been prepared in accordance with the scope of RPS's appointment with its client and is subject to the terms and conditions of that appointment. RPS accepts no liability for any use of this document other than by its client and only for the purposes for which it was prepared and provided.
2. If received electronically it is the recipient's responsibility to print to correct scale. Only written dimensions should be used.



rpsgroup.com

The Kemsley Mill K4 Combined Heat and Power Generating Station  
Development Consent Order

Title: Work No.1 - works plan with limits of deviation for vertical tube boiler

Scale 1: 250 @ A1  
0 5 10 15 20 Metres

Date: Mar 2018  
Author: R.Massey

Doc reference  
10392-0031-007

Document number  
4.9

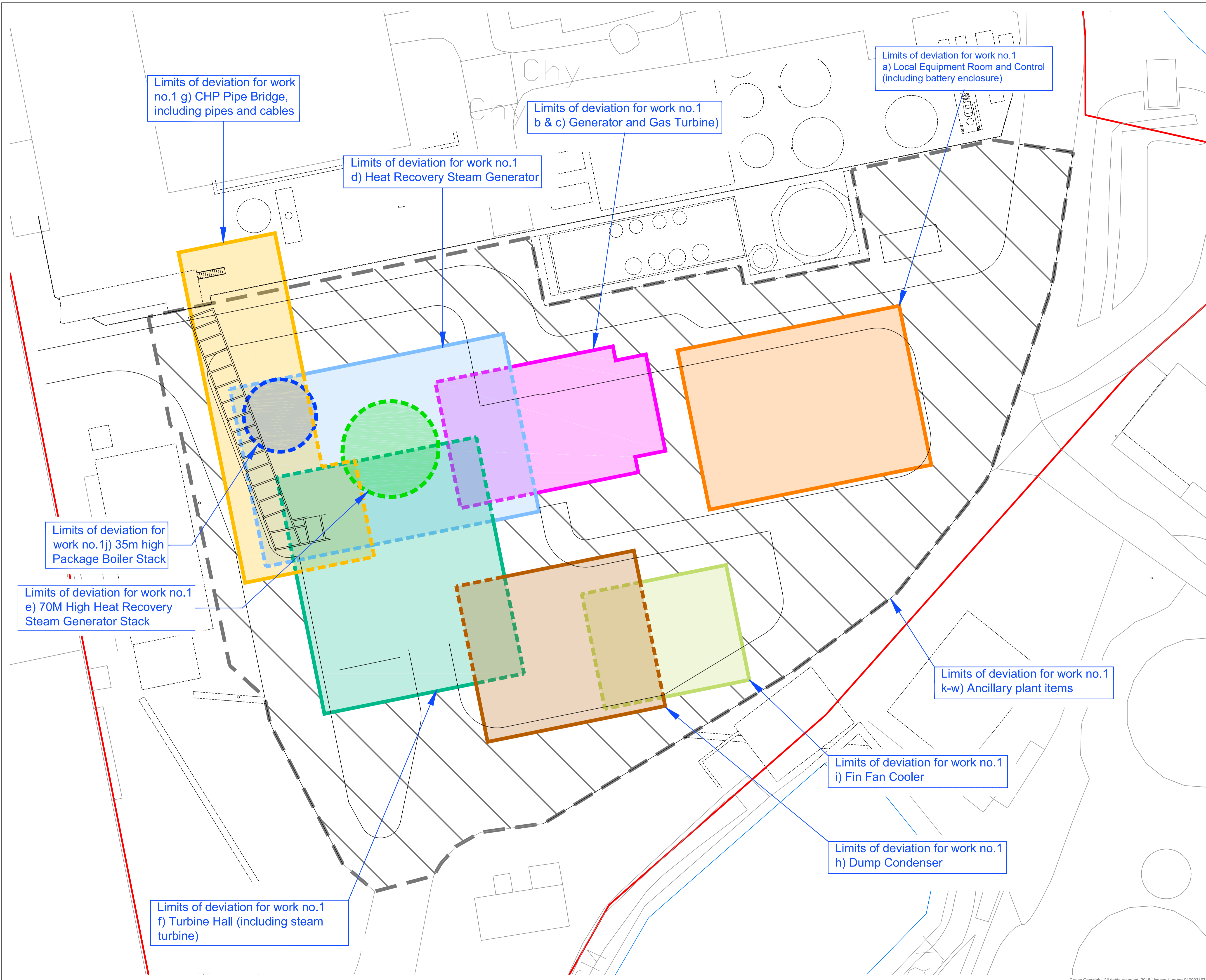

Limits of deviation for work no.1 g) CHP Pipe Bridge, including pipes and cables

Limits of deviation for work no.1 b & c) Generator and Gas Turbine)

Limits of deviation for work no.1 a) Local Equipment Room and Control (including battery enclosure)

Limits of deviation for work no.1 d) Heat Recovery Steam Generator

Limits of deviation for work no.1j) 35m high Package Boiler Stack

Limits of deviation for work no.1 e) 70M High Heat Recovery Steam Generator Stack

Limits of deviation for work no.1 k-w) Ancillary plant items

Limits of deviation for work no.1 i) Fin Fan Cooler

Limits of deviation for work no.1 h) Dump Condenser

Limits of deviation for work no.1 f) Turbine Hall (including steam turbine)